

SA25-90C50

SEMI-AUTOMATIC RETRACTABLE BOLLARD
WITHSTANDS THE IMPACT OF A 7.5-TONNE HGV AT 80 KM/H
H90 CM - Ø25 CM



**Operational after
a double crash test**

High security
level without
a power supply

Designed for
regular operation

Automatic lock in
high and low position

Surfaces exposed
to tread made of
stainless steel

STANDARD CHARACTERISTICS

• Cylinder:

- Zinc-plated steel with epoxy powder coating Ø 25 cm - H 90 cm
- RAL 7016 colour
- 20 mm thick stainless steel bollard top
- Brush seal prevents scratches on the housing
- Class 2 reflective tape

• Frame:

- Thick steel floor plate protected with a stainless steel cover
- 6 mm thick galvanised steel frame
- Lateral guidance with HDPE sliders
- Anchor bracket M16 strengthening the connection to the concrete Foundation

• Operation:

- European barrel lock protected bollard operating device
- Manual operation assisted by a hydraulic compensation device integrated into a compartment adjoining the bollard compartment

• Drive system: Biodegradable hydraulic oil with low viscosity variation

• Standards:

- NFP 98-310-compliant
- Dimensions compliant with the French Decree of 18/09/2012 on the accessibility of roads and public spaces



MADE IN FRANCE



SA25-90C50

TECHNICAL SPECIFICATION

Resistance	1,860,000 J
Paint / Finish	RAL 7016 steel colour
Cylinder dimensions (H-Ø)	900 mm / 250 mm
Floor plate dimensions	430 x 430 mm + hydraulic compartment 430 x 730 mm

CERTIFICATION

Resistance certified by double crash test with a functional bollard after impact:



7.5 tonnes at 48 km/h then 7.5 tonnes at 80 km/h

Tested in its automatic version

OPTIONAL FEATURES

Security

- Potential free position contact
- Snap-off nuts to secure access to the bollard
- Steel cage for reinforcing the Foundation according to test conditions
- Hanger set for sealing without prior work

Customisation

- Choice of RAL colour

INSTALLATION

Installation of the bollard with hangers or adjustable feet in 24 hours without prior structural work

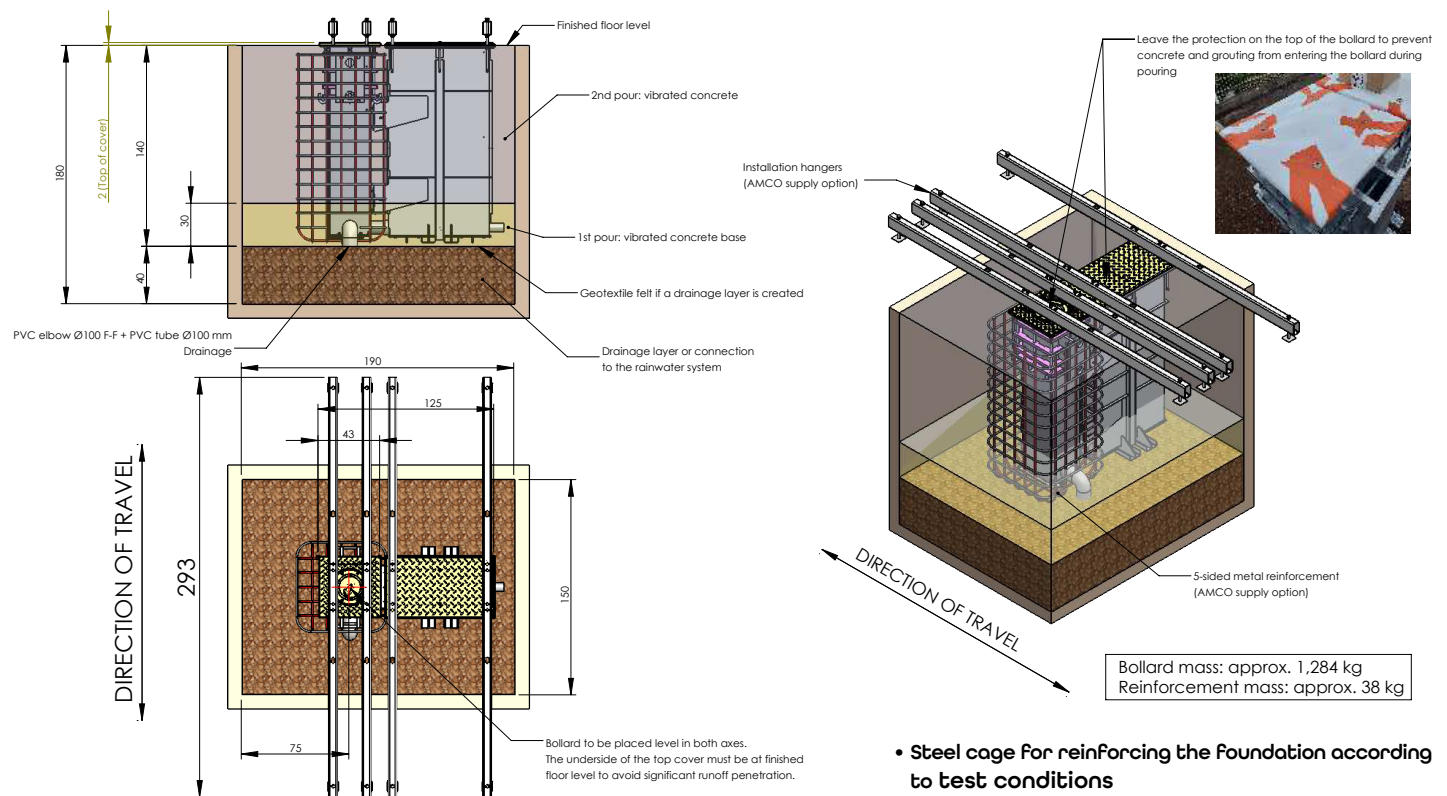

- Steel cage for reinforcing the Foundation according to test conditions
- Hanger set for sealing without prior work
- Adjustable Foot device for laying on concrete slab (option)

