

F10-100 3548

SAFE LINE SMALL POST -
WITHSTANDS THE IMPACT OF A 3.5-TONNE HGV AT 48 KM/H
H100 CM - Ø10 CM

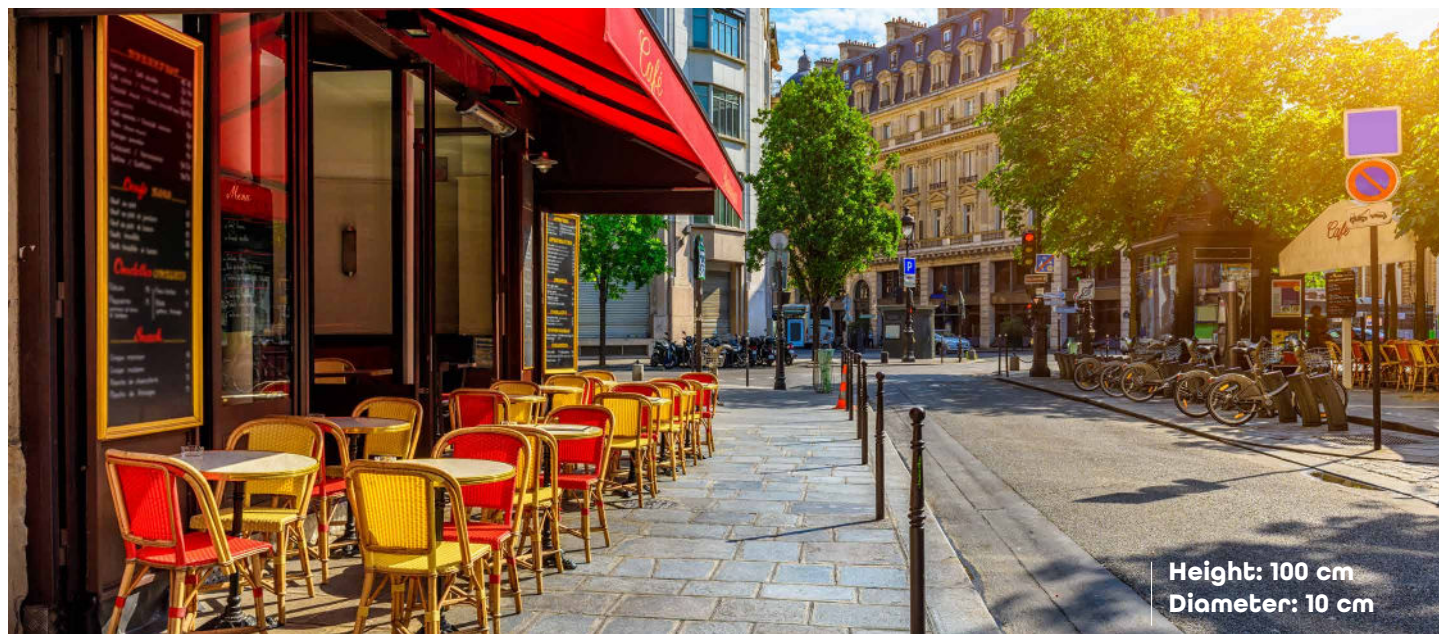

Interchangeable
stainless steel
sleeve

8 cm gap above
Foundation for Floor
Finish

Wide range of test
configurations

Resistant
and discreet

Very low sealing depth
<20 cm

STANDARD CHARACTERISTICS

• Cylinder:

• Steel version:

Steel cylinder treated with zinc plating and epoxy powder coating Ø 10 cm - height 100 cm

• Stainless steel version:

Hot-dip galvanised steel cylinder with stainless steel shell sleeve, microblasted Finish Ø 11 cm - height 100 cm

• Adjustment pads integrated into the base for levelling

• Installation:

- Small post axis 20 cm from the edge of the concrete Foundation or from the back of the curb



MADE IN FRANCE

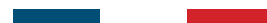

F10-100 3548

TECHNICAL SPECIFICATION

Resistance	216,000 J
Paint / Finish	RAL steel colour
Dimensions	Steel 10/100 cm Stainless steel 11/100 cm

CERTIFICATION

Impact resistance certified by digital crash test:



Frontal impact:

3.5 tonnes at 40 km/h

Impact at 45°:

3.5 tonnes at 48 km/h

OPTIONAL FEATURES

Security

- Reflective tapes

Customisation

- Choice of RAL colour
- Ø11 stainless steel sleeve on steel bollard

INSTALLATION

Pedestrian walkway at the same level as the road

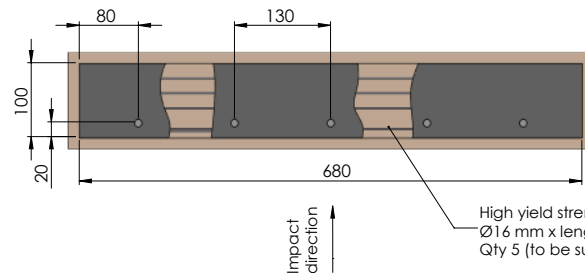
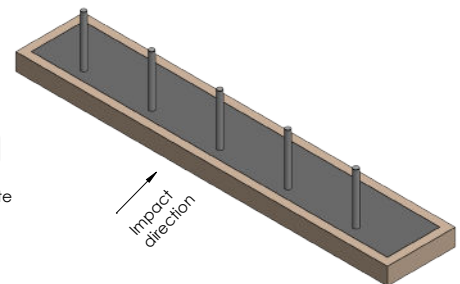
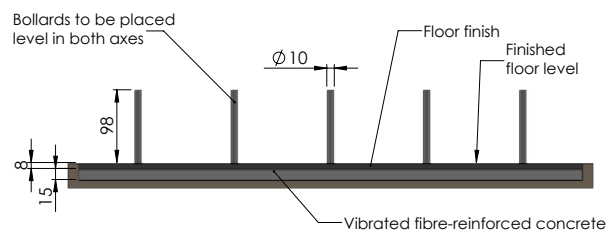

INSTALLATION METHOD:

- Carry out the excavation.
- Compact the bottom of the excavation.
- Sling the bollards and place them in the excavation.
- Level the bollards (in both axes).
- Fill the entire excavation with fibre-reinforced concrete, leaving 8 cm for the floor finishes.
- Install the stainless steel sleeve (optional)
- Finish the floors.

Pedestrian walkway separated from the road by a curb

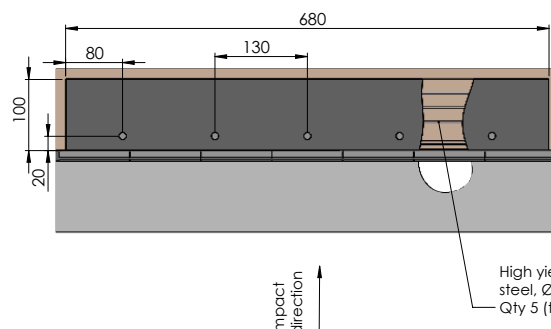
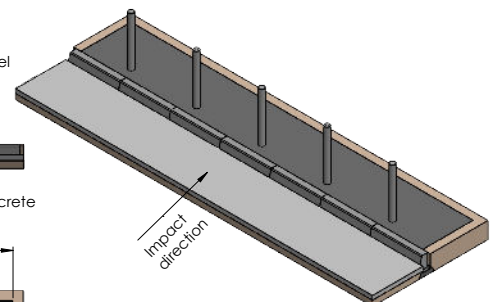
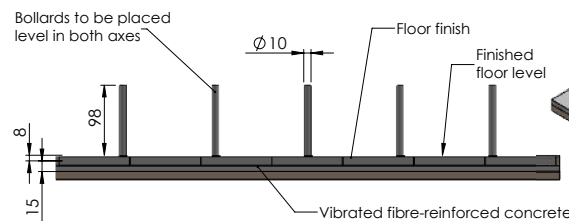

INSTALLATION METHOD:

- Carry out the excavation.
- Compact the bottom of the excavation.
- Sling the bollards and place them in the excavation.
- Level the bollards (in both axes).
- Fill the entire excavation with fibre-reinforced concrete, leaving 8 cm for the floor finishes.
- Install the stainless steel sleeve (optional)
- Finish the floors.

