

# EDR12

## RETRACTABLE POWER SUPPLY BOLLARD: WATER, ELECTRICITY, COMPRESSED AIR, ETC. UP TO SIX 230-V SOCKETS



Mechanism  
and support for  
all-stainless sockets

Cable guide  
integrated into  
the cover plate

Filling cover  
plate

Custom  
configurations

NFC 17-200 &  
NFC 15-100-compliant

### STANDARD CHARACTERISTICS

- Retractable power supply bollard
- **Retractable bollard:**
  - Gas-cylinder-assisted swivel opening
  - Custom double-pin lock
  - Differential circuit breakers protected under an IP66 window
  - Automatic ventilation of the junction box to remove condensation from the equipment (open bollard)
  - Equipment integrated on a stainless steel flange
- **Frame:**
  - Stainless steel frame
  - Stainless steel filling cover plate (ht 35 mm)
  - Cable guide for closed bollard use
  - High tread resistance in the closed position
  - Main disconnection by 63 or 125 A / 400 V disconnect switch
- NFC 17-200 / NFC 15-100-compliant



MADE IN FRANCE



## TECHNICAL SPECIFICATION

Power supply	400 V
Paint / Finish	Stainless steel
Frame dimensions (W-D-L)	350 x 490 x 740 mm
Filling cover plate dimensions (W-D-L)	340 x 35 x 460 mm

## OPTIONAL FEATURES

- Non-slip chequered stainless steel plate
- Heating element + hygrotherm
- Customisable electrical equipment
- Integrated water tap
- Electricity meter on sockets
- Low current
- Exogel system

## INSTALLATION

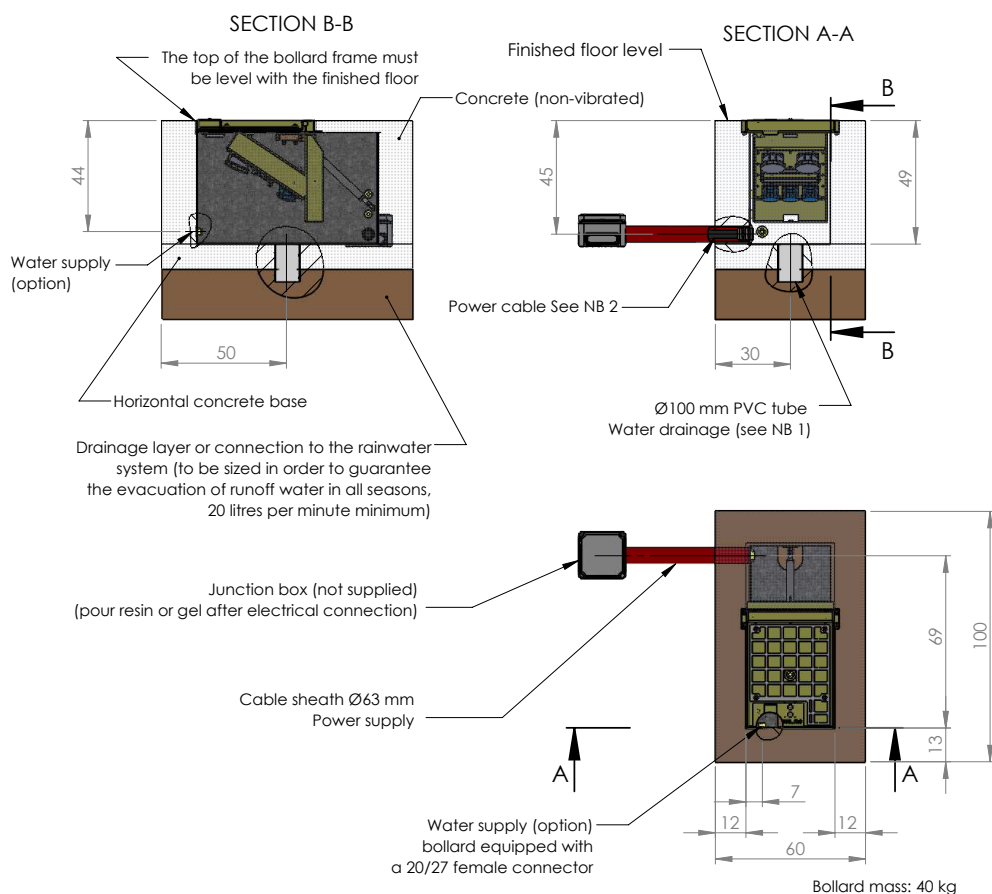

**Important:**  
The dimensions of the excavation correspond to the minimum concrete foundation. You will adapt them to facilitate connections or other operations performed by your personnel.

Filling bollard top (chequered stainless steel sheet optional)

