

LBAi W-GATE

ULTRA-FAST GATE WITH ARTIFICIAL INTELLIGENCE
FROM 2 TO 5 METRE CLEARANCE



Ultra-Fast
opening

Intelligent safety system with LBAi
detect or safety edges and cells
(optional)

**Drive system and
electronics integrated
into the post**

Complies with
standard EN 13 241-1,
approved by the CSTB

STANDARD CHARACTERISTICS

- **Passage width:** From 2 to 5 m
- **Continuous operation:** 6,000 cycles/day
- **Geared motor:** Drive system and electronics integrated into the post
- **Opening angle:** 90° (optional: 115°)
- **Post:** Technical post in cataphoresis treated steel + paint
- **Locking:** 500 kg electromagnet
- **Leaves:** (Frames and bars) in painted aluminium, polyester paint
- **Light signals:** Flash lights & area lighting
- **ONE-C control board comprising:** Power supply, PLC, frequency converter, SD card, RJ45 (Modbus) and torque limiter
- **LBAi Detect Intelligent Security System:** Artificial intelligence image analysis (optional)

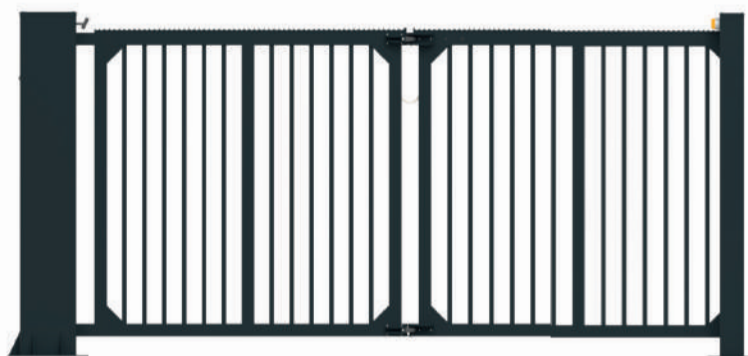

TECHNICAL SPECIFICATION

Power supply	230 V
Consumption	150 W
Geared motor	0.09 kW negative brake motor
MTBF	6000
Maximum leaf length	5 m
Height	2-2,5-3 m
Emergency operation	Brake release in posts
Temperature control	Thermostatically-controlled anti-condensation heating
Paint	250° polyester powder coating
Concrete Foundation dimensions (LxDxH)	600 x 800 x 600 mm
Operating temperature	-30° to +55° C
IP rating	55

OPTIONS

Customisation

- Choice of RAL colours
- Customisable leaves
- LBAi Detect: Customisable detection area depending on the site configuration and ensuring complete user safety
- Stylish aluminium sheet with LBA Design pattern

Audible & visual signals

- LED strips
- Red/green R23 light on post

Safety

- Infrared cells
- 2 infrared cell support posts
- Safety edges to be mounted on the secondary door leaf
- Defensive serrations to prevent climbing over

INSTALLATION

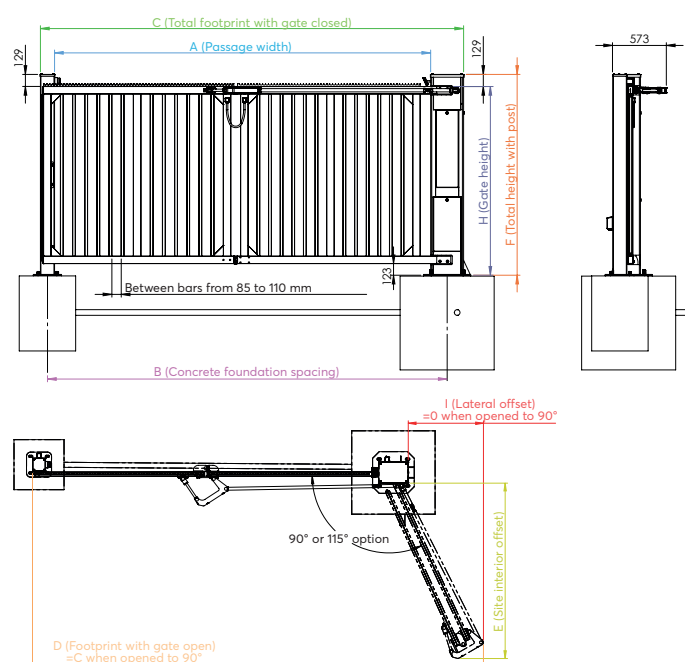

Power supply:

- Ø63 mm corrugated conduit
- U-1000 RO 2V 3 x 2.5 mm² cable

Remote control:

- Ø40 mm green corrugated conduit
- 5-pair 9/10 core telephone cable

Connection with reception post:

- Ø30 mm tube
- IR cell

Magnetic loop cable:

- Ø30 mm tube
- Twisted pair loop cable

Sealing template + 4 mounting rods:

- The template remains level in situ and must rest entirely on the concrete foundation

